



17 Watermead, Tadworth, KT20 5HB

Asking Price £220,000



- GROUND FLOOR MAISONETTE
- 0.21 MILES TO SHOPS, 0.65 TO STATION
- TWO HALL STORAGE CUPBOARDS
- FITTED KITCHEN
- COMMUNAL GARDEN TO REAR
- CUL-DE-SAC LOCATION
- DOUBLE BEDROOM
- BATHROOM
- OPEN PLAN LIVING/DINING ROOM
- HAPPILY TENANTED FOR 25 YEARS

A rarely available ground floor maisonette which has been happily tenanted for 25 years located in a cul-de-sac just 0.21 miles from local convenience shops and 0.65 miles to Tadworth station.

A private front entrance door leads to the main hallway with three generous storage cupboards. An open plan living/dining room with outlook to the communal grounds is situated adjacent to a fitted kitchen with ample storage cupboards, worksurfaces and space for white goods. The property benefits from a double bedroom with fitted storage along with a family bathroom.

There is also a communal garden space to the rear with washing lines for convenience. Parking is on a first come, first served basis.

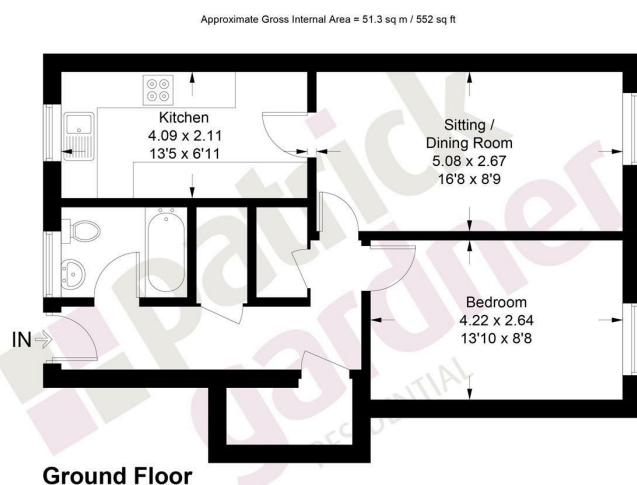

This plan is for layout guidance only. Not drawn to scale unless stated. Windows and door openings are approximate. Whilst every care is taken in the preparation of this plan, please check all dimensions, shapes and compass bearings before making decisions reliant upon them. (ID1224513)  
www.bagshawandhardy.com © 2025

<b>Tenure</b>	Leasehold
<b>Lease</b>	125 Years from 19/09/1988
<b>Service Charge</b>	£783.28 per annum
<b>Ground Rent</b>	£10 per annum
<b>EPC</b>	D
<b>Council Tax Band</b>	D

**66 Tudor House, Ashted, Surrey, KT21 1AW**  
**Tel:** 01372 271880 **Email:** ashted@patrickgardner.com  
**www.patrickgardner.com**

These particulars, whilst believed to be accurate are set out as a general outline only for guidance and do not constitute any part of an offer or contract. Intending purchasers should not rely on them as statements of representation of fact, but must satisfy themselves by inspection or otherwise as to their accuracy. No person in this firm's employment has the authority to make or give any representation or warranty in respect of the property.

